



Air Conditioning & Heating

# G13MU

## WHOLE-HOUSE, HIGH-EFFICIENCY MEDIA RETROFIT AIR CLEANER

### MERV<sup>§</sup> 14 RATED EFFICIENCY

#### Standard Features

- Removes airborne contaminants down to 0.3 micron on the first pass of air.
- Filter material uses both charged fibers and traditional mechanical filtration principles. The charged fibers allow the media to achieve MERV 14 levels upon installation.
- Extra deep, 5¼", 26-pleat filter contains more media material than other filters on the market. More surface area means more collection area, longer filter life, and lower static pressure.
- Filter fits snugly into cabinet
- User-friendly, easy-to-change filter cartridge
- Filter lasts up to one year in standard applications
- Reversible airflow
- Mounts in any position
- Easily upgrades to the new Goodman® "D Series" High-Efficiency Electronic Air Cleaner, which is capable of removing harmful contaminants as small as 0.01 micron (1/2,540,000 of an inch).

#### Cabinet Features

- Heavy-gauge galvanized-steel cabinet resists corrosion
- Trouble-free vertical or horizontal installation
- Durable powder-paint finish on door resists corrosion



#### Accessories

MODEL #	DESCRIPTION
1156-3	Activated Carbon Filters (3 per pack) for the G13MU1625
1856-3	Activated Carbon Filters (3 per pack) for the G13MU2025
EACK1625A	Upgrade Kit to GSASD-11 Electronic Air Cleaner includes Prefilters (2), Collecting Cells (2), Power Box (1) with Air Proving Switch and Contact Board
EACK2025A	Upgrade Kit to GSASD-18 Electronic Air Cleaner includes Prefilters (2), Collecting Cells (2), Power Box (1) with Air Proving Switch and Contact Board
G1-1056	Replacement filters (3 per box) for G13MU1625; replace 1-2 times per year
G8-1056	Replacement filters (3 per box) for G13MU2025; replace 1-2 times per year



\* Complete warranty details available from your local dealer or at [www.goodmanmfg.com](http://www.goodmanmfg.com).

<sup>§</sup> MERV: Minimum Efficiency Reporting Value based on ASHRAE Standard 52.2.



## SPECIFICATIONS

MODEL	G13MU1625	G13MU2025
Power Consumption	0	0
House Size	<3000 ft <sup>2</sup> <278.70 m <sup>2</sup>	>3000 ft <sup>2</sup> >278.70 m <sup>2</sup>
Airflow	up to 1400 cfm up to 2379 m <sup>3</sup> /hr	up to 2000 cfm up to 3398 m <sup>3</sup> /hr
Duct Size	16 x 25 in 40.5 x 63.5 cm	20 x 25 in 51 x 63.5 cm
Intake Dimensions (H x L)	13 <sup>5</sup> / <sub>8</sub> x 24 <sup>1</sup> / <sub>9</sub> in 34.6 x 61.2 cm	18.0 x 23 <sup>1</sup> / <sub>4</sub> in 45.7 x 59.1 cm
Cabinet Dimensions (W x H x L)	7 <sup>1</sup> / <sub>2</sub> x 17 <sup>2</sup> / <sub>5</sub> x 26 <sup>2</sup> / <sub>3</sub> in 19.1 x 44.2 x 67.3 cm	7 <sup>1</sup> / <sub>2</sub> x 22 <sup>2</sup> / <sub>3</sub> x 26 <sup>2</sup> / <sub>7</sub> in 19.05 x 56.6 x 66.8 cm
Weight	18 lb / 8.2 kg	20 lb / 9.1 kg
Pressure Drop	.081 (in./wg) @ 670 cfm .223 (in./wg) @ 1340 cfm	.09 (in./wg) @ 882 cfm .23 (in./wg) @ 1764 cfm
MERV Rating	13	13
<b>Efficiency On Micron Size</b>		
E1 (0.3 - 1.0 micron)	54%	54%
E2 (1.0 - 3.0 micron)	92%	92%
E3 (3.0 - 10.0 micron)	99%	99%

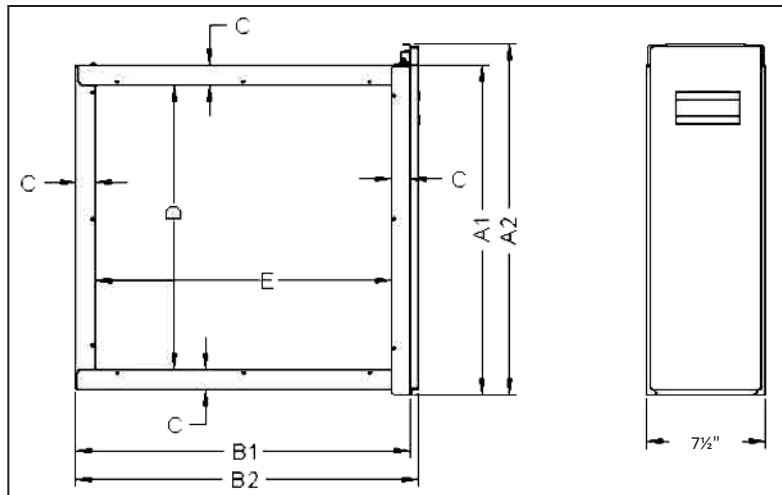

MODEL	DIMENSIONS " (CM)						
	A1	A2	B1	B2	C	D	E
G13MU1625	15.94 (40.5)	17.41 (44.2)	26.11 (66.3)	26.64 (67.7)	1 (2.6)	13.62 (34.6)	24.11 (61.2)
G13MU2025	20.83 (52.9)	22.3 (56.6)	25.76 (65.5)	26.29 (66.8)	1.25 (3.2)	18 (45.7)	23.26 (59.1)

MANUFACTURER RESERVES THE RIGHT TO DISCONTINUE OR CHANGE AT ANY TIME, SPECIFICATIONS OR DESIGNS WITHOUT NOTICE OR WITHOUT INCURRING OBLIGATIONS.  
 PERFORMANCE OF THE AIR CLEANERS WILL DEPEND ON HOUSE PLAN DESIGN, DUCT DESIGN AND HEATING/COOLING EQUIPMENT.  
 FOR MORE INFORMATION, CALL THE AIR CLEANER HELP LINE TOLL-FREE: 1-800-267-8305

